

Strategic Housing Land Availability Assessment (SHLAA)

Call for Sites Pro-forma

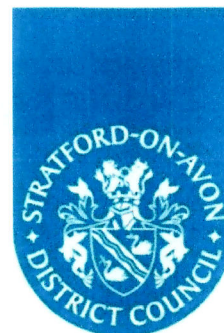

- Please complete this form if you would like to suggest land for future development in Stratford-on-Avon District. The sites will be assessed as part of the SHLAA and used in the preparation of the Site Allocations Plan which can be viewed at www.stratford.gov.uk/siteallocations.
- Please only submit sites capable of **delivering 1 or more homes**.
- Please complete a **separate form for each site**. Complete each section clearly and legibly to the best of your knowledge.
- You must attach a **1:1250 scale Ordnance Survey map** clearly showing the precise boundaries of the site and details of site ownership.
- You must **sign and date the declaration** at the end of the form.
- In submitting a site you consent for your **name and postal address to be made publicly available**.

1. Your Details (please provide details)

Title	MR. & MRS	Name	STEPHEN JONES, ELIZABETH JONES	
Organisation (if relevant)			Representing (if relevant)	
Address	THE ORCHARDS, LOWER TYSOE			
Post Code	CV35 6BN	Telephone	01295 680243	
Email	stephenjones11@gmail.com			

2. Site Location (please provide details)

Site Name	THE ORCHARDS		
Site Address (Inc. postcode if known)	LOWER TYSOE, WARWICK, CV35 6BN		
OS Grid Ref: Easting	434465	OS Grid Ref: Northing	244969
Total Site Area (Hectares)	1.58	Area of Site Suitable for Development	1.07

Please attach a 1:1250 scale Ordnance Survey map clearly showing the precise boundaries of the site with a red line. If appropriate, show other land in your ownership in blue. If relevant, also provide details of land parcels where the site is under multiple land ownership (see Section 3).

3. Site Ownership (please tick as appropriate and/or provide details)

Ownership (please tick)	Yes – sole owner <input checked="" type="checkbox"/>	Yes – part owner <input type="checkbox"/>	No <input type="checkbox"/>
If you are a part owner or are not the owner, please provide name(s) and address(s) of the other landowners			
Have you notified the (other) landowner/s that you have submitted this site?	Yes <input type="checkbox"/>	No <input type="checkbox"/>	

4. Site Constraints (on site or on the boundary) (please tick as appropriate and/or provide details)

Current / Previous Use	GARDEN				
Adjacent Land Uses	GARDEN				
Relevant Planning History					
Existing Infrastructure	Electricity <input type="checkbox"/>	Gas <input type="checkbox"/>	Mains Sewerage <input type="checkbox"/>	Mains Water <input type="checkbox"/>	Telecoms <input checked="" type="checkbox"/>
Access from the Highway	Yes (classified road) <input type="checkbox"/>	Yes (unclassified road) <input type="checkbox"/>	No <input checked="" type="checkbox"/>		
Highway Works					
Ransom Strips					
Legal Issues					
Existing Occupiers					

Public Access / Rights of Way	
Wildlife Designations (wildlife site, protected species)	
Heritage Designations (e.g. listed buildings)	
Agricultural Land Classification (If appropriate)	
Environment Constraints (e.g. mature trees, TPOs, ponds, watercourses)	
Physical Constraints (e.g. flooding, potential land contamination)	
Infrastructure Constraints (e.g. pylons, gas mains)	
Other Known Issues / Constraints	
Interventions to Overcome Constraints?	

5. Proposal Details (please tick as appropriate and/or provide details)

Proposed Development	Two plots, each with 6 3/4 bedroom detached houses.				
Proposed Land Use	Residential <input checked="" type="checkbox"/>	Employment <input type="checkbox"/>	Retail <input type="checkbox"/>	Mixed <input type="checkbox"/>	Other <input type="checkbox"/>
Site Capacity / Density (i.e. no. of homes / floor space)	≈ 890m ²				
Potential for Development	Marketed for Development <input type="checkbox"/>	Negotiations with a Developer <input type="checkbox"/>	In control of a Developer <input type="checkbox"/>		
Availability for Development	Short-term (within 5 yrs) <input checked="" type="checkbox"/>	Medium-term (6-10 yrs) <input checked="" type="checkbox"/>	Long-term (11+ yrs) <input type="checkbox"/>		
Development Timescale / Phasing (Inc. build rates)	Develop in two phases commencing within the next 10 years.				

6. Continuation Section

Signature

In submitting a site you consent for your name and postal address to be made publicly available and for a representative of the Council to access the site (if necessary) to undertake a site assessment with or without prior notification.

Your details will also be added to the Council's Planning Policy database and you may receive notifications of forthcoming public consultations and stages of plan preparation. You can request that your details are removed from the database at any time.

Name	STEPHEN JONES
Signature	
Date	30/10/16
Please return completed forms to Jane Millward (Parish Clerk) - email parishclerk.tpc@gmail.com	

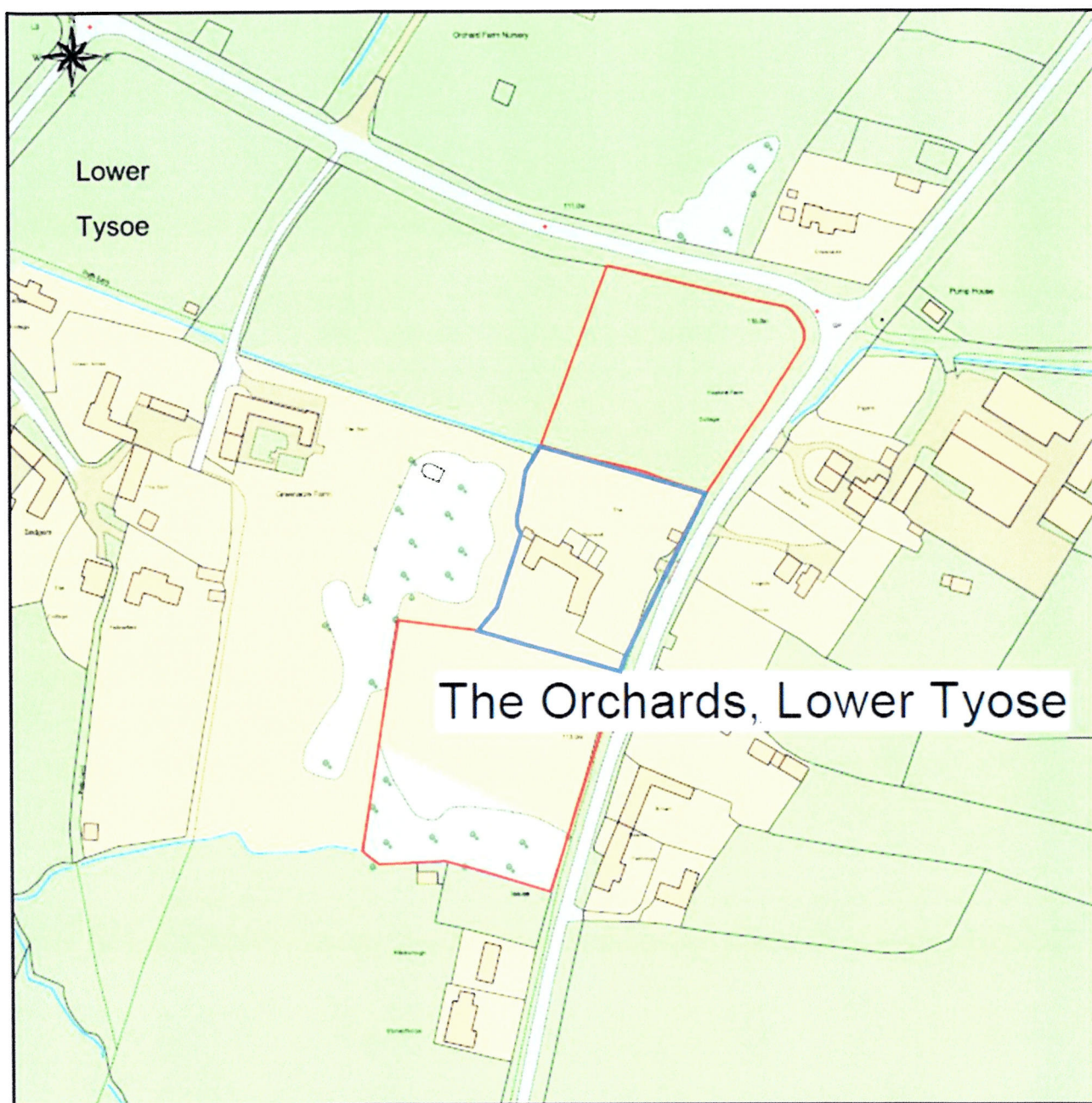

This Plan includes the following Licensed Data: OS MasterMap Colour PDF Location Plan by the Ordnance Survey National Geographic Database and incorporating surveyed revision available at the date of production. Reproduction in whole or in part is prohibited without the prior permission of Ordnance Survey. The representation of a road, track or path is no evidence of a right of way. The representation of features, as lines is no evidence of a property boundary. © Crown copyright and database rights, 2016. Ordnance Survey 0100031873

0m 25m 50m 75m 100m 125m 150m 175m 200m

Scale: 1:2500, paper size: A4

